

Wiring

This unit is only capable of being wired in Non Maintained configuration.

Identify the permanent live and connect to the connection block inside the product in the following way:

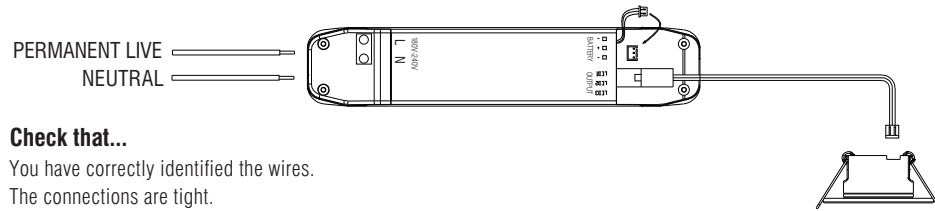

Check that...

You have correctly identified the wires.

The connections are tight.

No loose strands have been left out of connection block.

Operating Instructions

Non Maintained: Lamp is normally off and battery is on automatic charge (LED is green) when the mains supply is present

Fitting automatically switches on the lamp when the supply is interrupted.

Connect the unit to the mains (220-240V a.c.). Verify that the green LED is illuminated; this confirms that the batteries are charging.

Charge the battery for at least 24 hours before first use.

The LED will be green, showing that mains power is present and the battery is being charged.

If the LED is not illuminated then there may be no A.C. supply, the battery has not been connected properly or the internal circuit may have failed.

Battery Replacement

If after routine operation check, the lamp does not remain lit for the three hour period, a new battery pack may be required.

- Switch off the electricity at the mains.
- Allow batteries to fully discharge then reconnect to supply and allow to charge for 24 hours.
- Test again for 3 hours, If light does not remain lit change the battery pack as follows:
- Ease the recessed unit out from the ceiling, and gently pull the cables to access the emergency.
- Loose the screws to open the emergency cover to remove battery.
- Write current date on the new battery.
- Put the new battery into the emergency cover and tighten the screws to replace the cover.
- Refit the emergency and recessed unit in the ceiling.
- Restore power and allow to charge for 24 hours.
- Perform full operation check and update test record.

Care and Safety

We recommend cleaning with a soft dry cloth. Do not use solvents or abrasive cleaners as these could damage the finish.

For your safety, always switch off the power supply before cleaning.

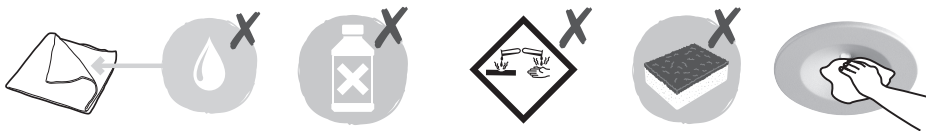

Instruction manual

SIGHT DOWNLIGHT

90633

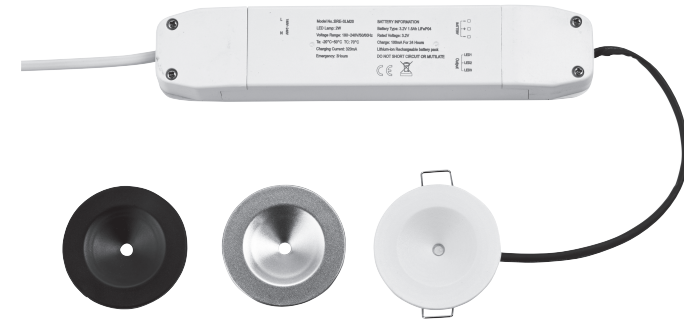

V4 17/06/2022

UK Manufacturer: BH17 7BY

EU Manufacturer: Brilliant AG,
Brilliantstrasse 1, D-27442 Gnarrenburg

saxby
lighting

www.saxbylighting.com

saxby
lighting

Thank you for purchasing this light fitting. Please read the instructions carefully before use to ensure safe and satisfactory operation of this product. Please retain these instructions for future reference.

Warning

 This light fitting is double insulated and does not require connection to an Earth circuit.

Live Voltages may be present in this unit even when turned off or when completely disconnected.

Please read these instructions carefully before commencing any work.

This unit must be fitted by a competent and qualified electrician.

Install in accordance with the IEE Wiring regulations and current Building Regulations.

Check the pack and make sure you have all the parts listed.

To prevent electrocution switch off at the mains supply before installing or maintaining this fitting. Ensure other persons cannot restore the electrical supply without your knowledge. If you are in any doubt, please consult a qualified electrician.

This light fitting should be connected to a fused circuit.

If replacing an existing fitting, make a careful note of the connections.

This system contains non-replaceable parts and cannot be serviced. If damage occurs the part should be scrapped.

These products should not be fitted to PIR circuits or short duration timed switches.

Waste electrical products should not be disposed of with household waste. Please recycle where facilities exist. Check with your local authority or retailer for recycling advice.

Technical data

Supply Voltage: 220-240 V~, 50Hz

Duration: 3 hours (180 minutes)

Change over Time: <1s

Battery Spec: LiFePO4 3.2V 1500mAh

Bulb Type: 2W LED Hi Power, 6500K

Operating Temperature: -20 °C to 40 °C

Battery Charge Time: 24 hours

Maximum Ambient Temperature: 40 °C

Battery warranty: 2 years



Conformity with all relevant UKCA Directive requirements.



Conformity with all relevant EC Directive requirements.



The power supply is Double Insulated and does not require connection to an Earth circuit.



Waste electrical products should not be disposed of with household waste. Please recycle where facilities exist. Check with your Local Authority or local store for recycling advice.



This product is not suitable for dimming.



This product is rated at IP20.

Layout

Plan the desired layout of these fittings carefully, ensuring the cables will reach the distances between each light fitting.

Avoid locating any cables in positions that would cause a hazard. Position cables and junction boxes (not supplied) away from areas where they may be at risk from being cut, trapped or damaged.

The mains supply cable must have a minimum cross section area of 1.0mm²

Cables must be protected using suitable conduit or plastic trunking.

Installation

Existing fittings must be completely removed before installation of a new product. Before removing the existing fitting, carefully note the position of each set of wires.

Note that the switch is turned off before installation.

Ensure free movement of air around the fitting by removing any roof void insulation from at least 100mm around the hole, under no circumstances must these fittings be covered with insulating or similar material.

The ceiling surface must be flat and smooth to ensure a good fit.

After deciding the layout of the light fittings ensure that the cables are long enough to connect to desired positions.

Ensure a minimum ceiling void depth of 190mm is available.

Ensure free movement of air around the fitting by removing any roof void insulation from at least 150mm around the hole. Under no circumstances must these fittings be covered with insulating matting or similar material.

When more than one downlight is installed, the minimum distance between units is 500mm.

- Cut a mounting hole $\varnothing 50\text{mm}$ in the ceiling taking care not to foul any pipes (Ref. Fig.1), mains cables or joists beneath the surface. It is always recommended to cut the hole slightly smaller than the size specified, and then file the hole until the recessed unit fits snugly.
- Loosen the screws to open the terminal block cover, Connect the mains supply cable into the terminals, wire details as wiring diagram.(Ref. fig. 2)
- Feed the emergency pack in to the ceiling(Ref. fig. 3)
- Push the connector into the head (Ref. fig. 4).
- Push the spring clips upwards and fit into the ceiling hole, then push the unit up until firmly in position, ensuring that no cables are trapped (Ref. Fig. 5).
- Ensure that the product is sitting properly in the hole.
- Switch on. Your light is now ready for use.

Fig. 1

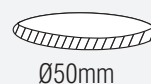

Fig. 2

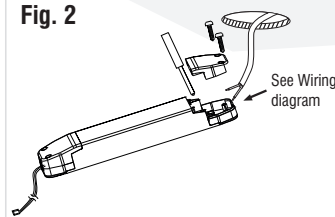

Fig. 3

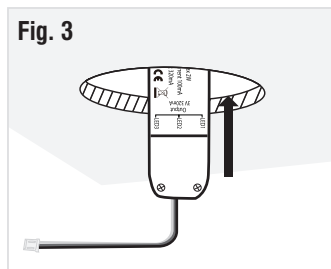

Fig. 4



Fig. 5

